Operating Manual



Applicable models:
W96B-TO, W96PANEL-TO
BV-96B.TO, BV96PANEL-TO

Table of contents

1	General	2
1.1	Information on this manual	2
1.2	Warning notices	2
1.3	Limitation of liability.....	2
2	Safety	2
2.1	Intended use.....	2
2.2	General Safety information	2
2.3	Sources of danger	3
2.3.1	Risk of fire / flammable materials used. Danger of burns or of explosion	3
2.3.2	Dangers due to electrical power.....	3
3	Commissioning	3
3.1	Safety information.....	4
3.2	Delivery scope and transport inspection	4
3.3	Unpacking.....	4
3.4	Setup location requirements.....	4
3.5	Electrical connection	4
4	Design and Function	5
4.1	Appliance dimensions	5
4.2	Installation dimensions	5
4.3	Appliance ventilation	6
4.4	Complete overview	6
4.5	Changing the direction in which the door opens and attaching a panel.....	6
4.6	Installation in a kitchen cabinet and attaching handle (if applicable)	7
4.7	Aligning the door.....	14
4.8	How to open the door.....	14
4.9	Wooden shelves	14
4.9.1	How to remove a shelf	14
4.9.2	How to insert a shelf	14
4.9.3	Wood storage shelf with presentation rack.....	14
4.10	Option for bottle storage	14
4.10.1	Standard storage.....	15
4.10.2	Bottle storage with presentation rack	15
4.11	How to change the activated carbon filter	16
4.12	Rating plate.....	16
5	Operation and Handling	17
5.1	Operating elements	17
5.1.1	Symbols shown on the control panel	17
5.2	Operation of the appliance	17
5.2.1	Switching on and off	17
5.2.2	Setting the temperature	17
5.3	Illumination	17
5.3.1	Setting the “ECO” mode	17
5.3.2	Setting light intensity	17
5.4	How to turn off the sound.....	17
6	Cleaning and Maintenance.....	17
6.1	Safety information.....	18
6.2	Cleaning.....	18
7	Troubleshooting.....	18
7.1	Safety notices.....	18
7.2	Troubleshooting table	18
8	Disposal of the Old Device	18
8.1	Disposal of the packaging.....	18
9.0	Warranty terms.....	19

1 General

Please read the information contained herein so that you can become familiar with your device quickly and take advantage of the full scope of its functions. Your device will serve you for many years if you handle it and care for it properly. We wish you a lot of pleasure in using it!

1.1 Information on this manual

These Operating Instructions are a component of the SH-96P (referred to hereafter as the Device) and provide you with important information for the initial commissioning, safety, intended use and care of the device.

The Operating Instructions must be available at all times at the device. This Operating Manual must be read and applied by every person who is instructed to work with the device:

- Commissioning,
- Operation,
- Troubleshooting and/or
- Cleaning

Keep the Operating Manual in a safe place and pass it on to the subsequent owner along with the device.

1.2 Warning notices

The following warning notices are used in the Operating Manual concerned here.

DANGER

A warning notice of this level of danger indicates a potentially dangerous situation. **If the dangerous situation is not avoided, this can lead to death or serious injuries.**

- ▶ Observe the instructions in this warning notice in order to avoid the danger of death or serious personal injuries.

WARNING

A warning notice of this level of danger indicates a possible dangerous situation. **If the dangerous situation is not avoided, this can lead to serious injuries.**

- ▶ Observe the instructions in this warning notice in order to avoid the personal injuries.

ATTENTION

A warning notice of this level of danger indicates a possible dangerous situation. **If the dangerous situation is not avoided, this can lead to slight or moderate injuries.**

- ▶ Observe the instructions in this warning notice in order to avoid the personal injuries.

PLEASE NOTE

A notice of this kind indicates additional information, which will simplify the handling of the machine.

1.3 Limitation of liability

All the technical information, data and notices with regard to the installation, operation and care are completely up-to-date at the time of printing and are compiled to the best of our knowledge and belief, taking our past experience and findings into consideration. No claims can be derived from the information provided, the illustrations or descriptions in this manual.

The manufacturer does not assume any liability for damages arising as a result of the following:

- Non-observance of the manual
- Uses for non-intended purposes
- Improper repairs
- Technical alterations, modifications of the device
- Use of unauthorized spare parts

Modifications of the device are not recommended and are not covered by the guarantee. All translations are carried out to the best of our knowledge. We do not assume any liability for translation errors, not even if the translation was carried out by us or on our instructions. The original German text remains solely binding.

2 Safety

This chapter provides you with important safety notices when handling the device. The device corresponds with the required safety regulations. Improper use can result in personal or property damages.

2.1 Intended use

This appliance is only intended for domestic use in closed rooms for cooling wine and other beverages. The appliance is only intended for use as a built-in cooler.

This appliance is intended for use in the home and in similar applications such as

- staff kitchen areas in shops, offices and other work areas;
- in agriculture and by guests in hotels, motels and other accommodation;
- bed and breakfasts.

Uses for a different purpose or for a purpose which exceeds this description are considered incompatible with the intended or designated use.

WARNING

Danger due to unintended use! Dangers can emanate from the device if it is used for an unintended use and/or a different kind of use.

- ▶ Use the device exclusively for its intended use.
- ▶ Observe the procedural methods described in this Operating Manual.

Claims of all kinds due to damages resulting from unintended uses are excluded. The User bears the sole risk.

2.2 General Safety information

PLEASE NOTE

Please observe the following general safety notices with regard to the safe handling of the device.

- ▶ Examine the device for any visible external damages prior to using it. Never put a damaged device into operation.
- ▶ If the power cord of this appliance is damaged, it must be replaced by the manufacturer, its customer service or a similarly qualified person to avoid hazards.
- ▶ This unit may be used by children as of 8 years old and anyone with reduced physical, sensory or mental capabilities or a lack of experience and knowledge if they are supervised or have been instructed in connection with the safe use of the appliance and the dangers resulting from it.
- ▶ Cleaning and maintenance by the user must not be performed by children.
- ▶ Children are not allowed to play with the device.

PLEASE NOTE

- ▶ The device and its connecting cable must be kept away from children who are less than 8 years old.
- ▶ Do not make any modifications to the appliance or the power cord. Only have repairs carried out by a specialist workshop as appliances that have not been repaired properly endanger the user. Please also observe the enclosed warranty conditions.
- ▶ Defective components must always be replaced with original replacement parts. Only such parts will guarantee that the safety requirements are fulfilled.
- ▶ Pull out the drawers by the recessed grips. Watch your fingers, so they do not get caught between the drawers and the unit.
- ▶ The power outlet must be freely accessible in case you need to disconnect the appliance from the mains quickly.
- ▶ If the door is left open for a longer period of time this may result in a significant rise in temperature around the appliance's shelves.
- ▶ If the cooler is left empty for a longer period of time, you should turn it off, defrost it, clean it and leave the door open to prevent mould forming.
- ▶ Use the appliance only as described in the user's guide to avoid possible injury from misuse.
- ▶ Do not use the appliance:
 - if the appliance itself or parts are damaged,
 - if the power cord or plug is damaged,
- ▶ Always unwind the power cord completely before use. When doing so, ensure that the power cord is not damaged by sharp edges or hot objects.
- ▶ Only use the appliance with original accessories.
- ▶ A space 560-570 cm x 1774,5 cm x 560 cm in size is required for installation of the appliance (see the "Installation dimensions" illustration).
- ▶ Please note the minimum clearance to surrounding fixtures as shown in the "Appliance ventilation" illustration.
- ▶ Install the appliance as described in the "Installation in a kitchen cabinet" section.

2.3 Sources of danger

2.3.1 Risk of fire / flammable materials used. Danger of burns or of explosion

DANGER

There is a danger of burns and explosion due to excess pressure that is created in the event the device is not used properly.

DANGER

Observe the following safety notices to avoid dangers of burns or an explosion:



Warning: Risk of fire / flammable materials used.

- ▶ Do not store explosive substances in this appliance, such as aerosol containers with flammable propellant gas.
- ▶ Blowing gas inside the unit is flammable.
- ▶ Do not damage the cooling circuit of the device.
- ▶ Do not use electrical devices inside the device.
- ▶ Do not use mechanical devices or other means to accelerate the defrosting process.
- ▶ Never use the device to store or dry flammable materials. Never clean appliance parts with flammable fluids. The fumes can create a fire hazard or explosion.
- ▶ Do not store or use gasoline or any other flammable vapours and liquids in the vicinity of this or any other appliance. The fumes can create a fire hazard or explosion.

2.3.2 Dangers due to electrical power

DANGER

Mortal danger due to electrical power!

Mortal danger exists when coming into contact with live wires or subassemblies!

Observe the following safety notices to avoid dangers due to electrical power:

- ▶ Do not open the housing on the device under any circumstances. There is a danger of an electrical shock if live connections are touched and the electrical or mechanical structure is altered. In addition, functional faults on the device can also occur.
- ▶ Do not operate this device if it has a damaged cable or plug, if it is not working properly or if it has been damaged or dropped. If the power cable or plug are damaged, then they must be replaced by the manufacturer or its service agent in order to avoid a hazard.

3 Commissioning

This chapter provides you with important safety notices during the initial commissioning of the device. Observe the following notices to avoid dangers and damages:

3.1 Safety information

WARNING

- ▶ Packaging materials may not be used for playing. There is a danger of suffocation.
- ▶ Use two persons to transport, unpack and set down the appliance because of its heavy weight.

3.2 Delivery scope and transport inspection

The device includes the following components:

- 15 x wooden shelf with ball bearing runners or 6 x glass shelves for beverage coolers
- 1 x wooden shelf or 1 x base shelf for beverage coolers
- Spare screws to change the direction in which the door opens
- Operating instructions

Scope of delivery for installation

1. 2 x mounting brackets
2. 2 x covers for the mounting brackets
3. 2 x spacers
4. 1 x Hinge cover PP1
5. 1 x Hinge cover PP2
6. 6 x screws
7. 1 x Wrench
8. 1 x Suction cup
9. 3 x cover profiles

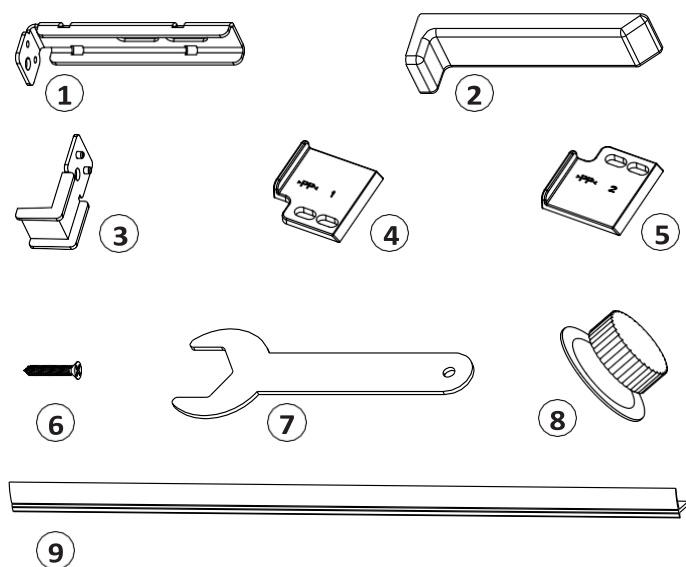

PLEASE NOTE

- Examine the shipment for its completeness and for any visible damages.
- Immediately notify the carrier, the insurance and the supplier about any incomplete shipment or damages as a result of inadequate packaging or due to transportation.

3.3 Unpacking

To unpack the appliance, proceed as follows:

- Take the appliance out of the carton and remove the internal and external packaging material.
- Always transport the appliance standing upright.
- Do not tilt the appliance by more than 45 degrees as this may damage the cooling system.
- Clean the interior surfaces with lukewarm water using a soft cloth.
- Wait at least 24 hours before you plug the appliance into mains power and turn it on. Only then should you place wine bottles or beverages in the appliance.

PLEASE NOTE

- Only remove the blue protective film shortly before setting up the device in the location where it will be used, to prevent scratches and dirt accumulations.
- If possible, keep the original packaging for the device for the duration of the guarantee period of the device, in order that the device can be re-packaged properly in the event of a guarantee claim.

⚠ WARNING

- Warning! A non-installed appliance may tip over!

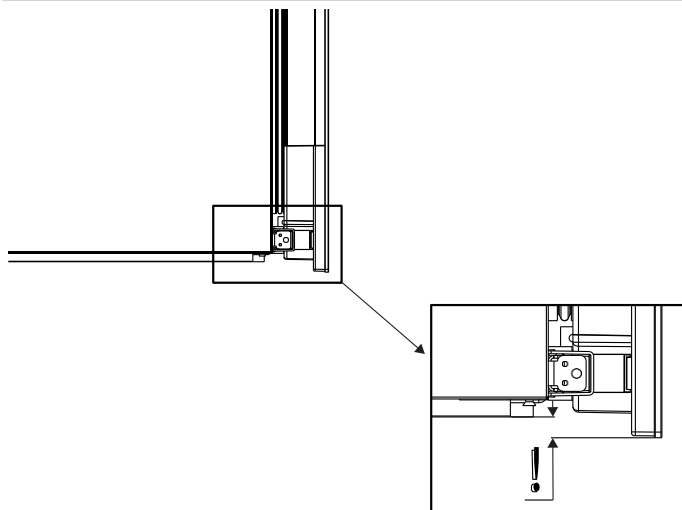

3.4 Setup location requirements

In order to ensure the safe and trouble-free operation of the device, the setup location must fulfil the following prerequisites:

- Only install your appliance in a piece of furniture which is suitable for this purpose and can bear the weight of the appliance even when completely full.
- Locate the appliance away from direct sunlight and sources of heat (stove, heater, radiator, etc.). Direct sunlight and heat sources may adversely affect energy consumption and cooling performance.
- This unit is not designed for use in a garage or any other outside installation.
- This cooling appliance is intended for ambient temperatures of 16-38 °C.

⚠ WARNING

Fire hazard due to moisture!

- If live parts or the power cord get wet, this can lead to short circuits.
- The appliance is intended for use in closed rooms. Do not operate the appliance outdoors or in areas where it is exposed to splashing water or moisture.

- Do not set up the appliance in a hot environment or near flammable material.
- **WARNING:** Do not block the ventilation openings in the appliance housing (and installation housing).
- The power socket must be easily accessible so that the power cord can be disconnected easily in case of an emergency.
- For energy saving reasons please ensure that the door is closed when the appliance is turned on.

3.5 Electrical connection

In order to ensure the safe and trouble-free operation of the device, the following instructions must be observed for the electrical connection:

- Connect the appliance to a properly installed power outlet with electrical data corresponding to the rating plate's specifications.
- The connection between the device and the electrical network may employ a 3 meter long (max.) extension cable with a cross-section of 1.5 mm². The use of multiple plugs or gangs is prohibited because of the danger of fire that is involved with this.
- Do not bend the power cord. Place the power cord in a way so that you do not trip over it. Make sure that the power cable is undamaged and has not been installed under or over hot or sharp surfaces.
- This unit is not designed to be installed in an RV or used with an inverter.

- The electrical outlet must be protected by a 16A safety cut-out switch.
- The electrical safety of the device is only guaranteed if the device is connected to a properly installed protective conductor system. If in doubt, have the house installation checked over by a qualified electrician. The manufacturer cannot be made responsible for damages that are caused by a missing or damaged protective conductor.

4 Design and Function

This chapter provides you with important safety notices on the design and function of the device.

4.1 Appliance dimensions

Side view

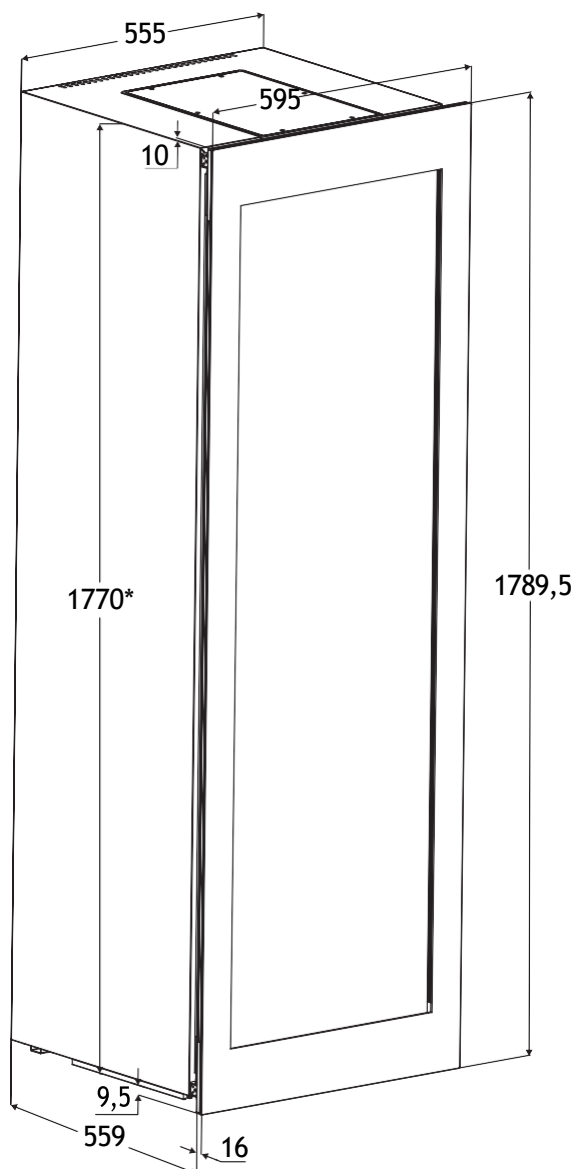

* The adjustable feet can be used to increase the installation height to max. 1785 mm within the housing.

The finishing glass panel is 16mm thick, if using an overlay panel then we suggest a thickness of 13-22mm to avoid the hinges binding and simpler installation.

View from above

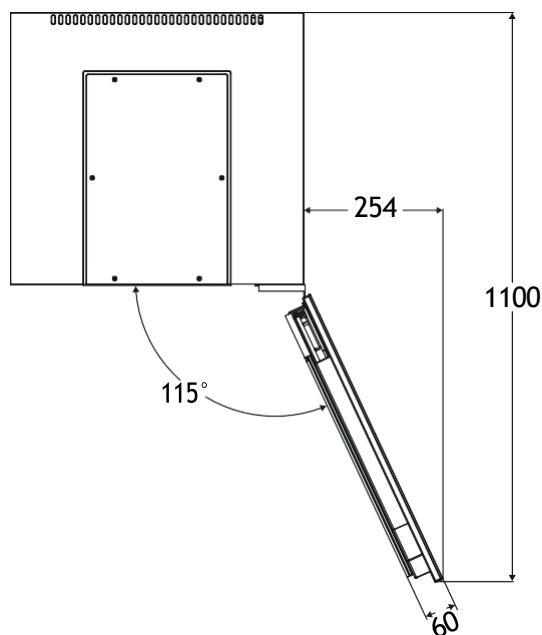

4.2 Installation dimensions

The kitchen cupboard must be aligned horizontally and vertically.

PLEASE NOTE

- Minimum carcass wall thickness = 16 mm.

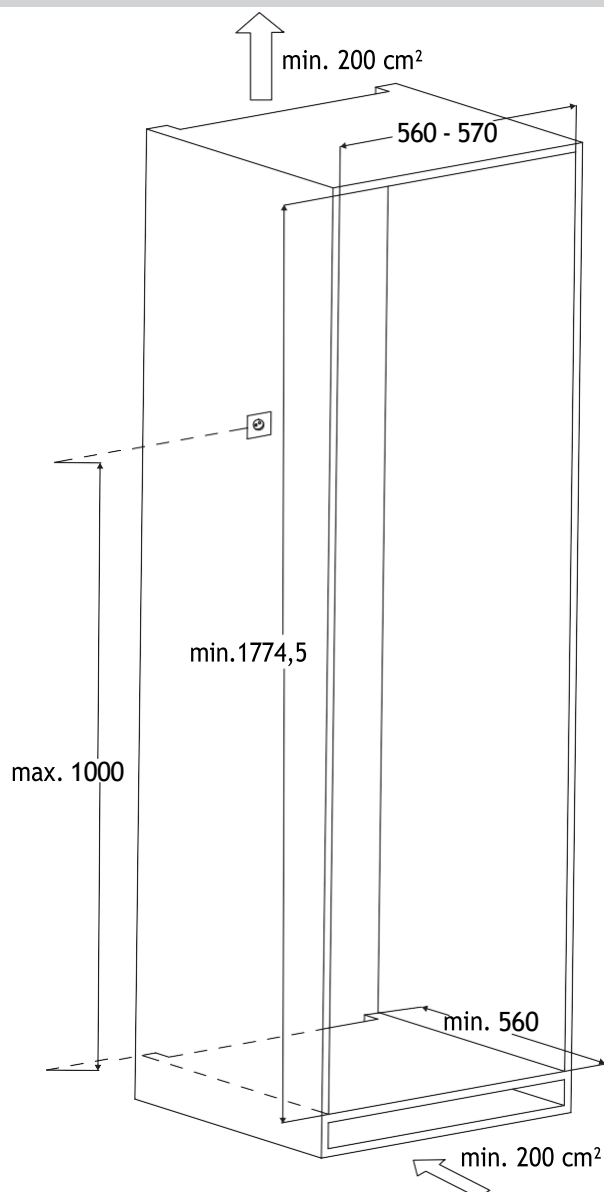

The power socket should be adjacent to the appliance and must be easily accessible. The appliance may only be installed by trained personnel. This requires at least two persons due to the weight of the appliance. Check the installation dimensions before installation.

4.3 Appliance ventilation

PLEASE NOTE

- The ventilation shaft must be at least 200 cm² in size, measured from the lower ventilation opening to the top of the back of the appliance.

Critical appliance ventilation requirements:

1. Directly above the appliance
2. Above the installation cabinet
3. On the front of the installation cabinet, covered with a decorative grille

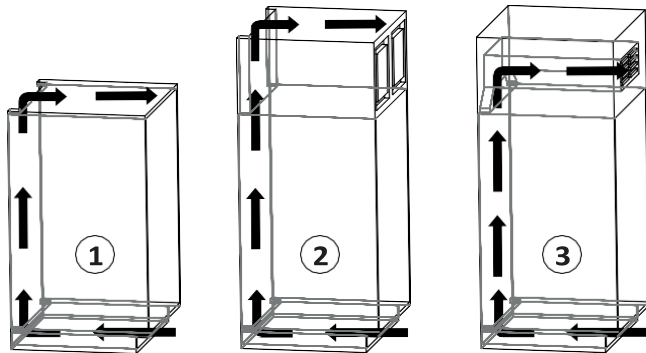

PLEASE NOTE

- If decorative grilles are used, please ensure that the cross-section of open ventilation equals the total area of the individual openings in the grille. A cross-section area of 200 cm² is therefore insufficient if a ventilation grille is installed.
- Failure to comply with the ventilation requirements of the appliance will void the warranty as the cooling capacity and/or the lifespan of the fridge will be effected - please consult page 19 for warranty conditions.

4.4 Complete overview

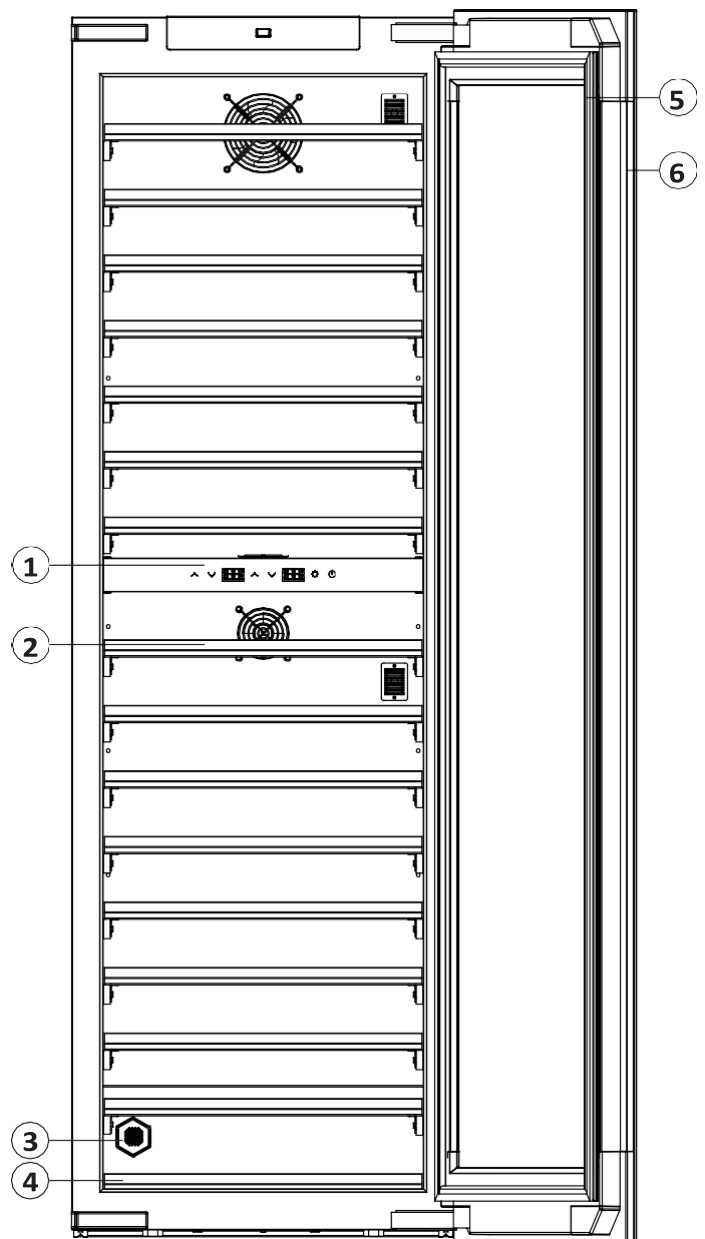

- | | |
|---------------------------------|-----------------------|
| ① control panel | ④ base shelf |
| ② wooden shelf or glass shelves | ⑤ sealing of the door |
| ③ activated carbon filter | ⑥ door frame |

4.5 Changing the direction in which the door opens

Door hinges should only be changed by a trained specialist. At least two persons are required to change the door hinges. If you want to change the direction which the door opens, you should do this BEFORE installation.

⚠ WARNING

Risk of injury and damage to property

- Heavy weight of the door. Only carry out the modification if you can lift the weight of the door.
- Risk of injury if the door falls out! The door may fall out if the hinges are not screwed in properly. This may result in serious injuries and damage to the door.

1. Disconnect the appliance from mains power when changing the door hinges.
2. Open the door.
3. Remove the hinge covers and screws.

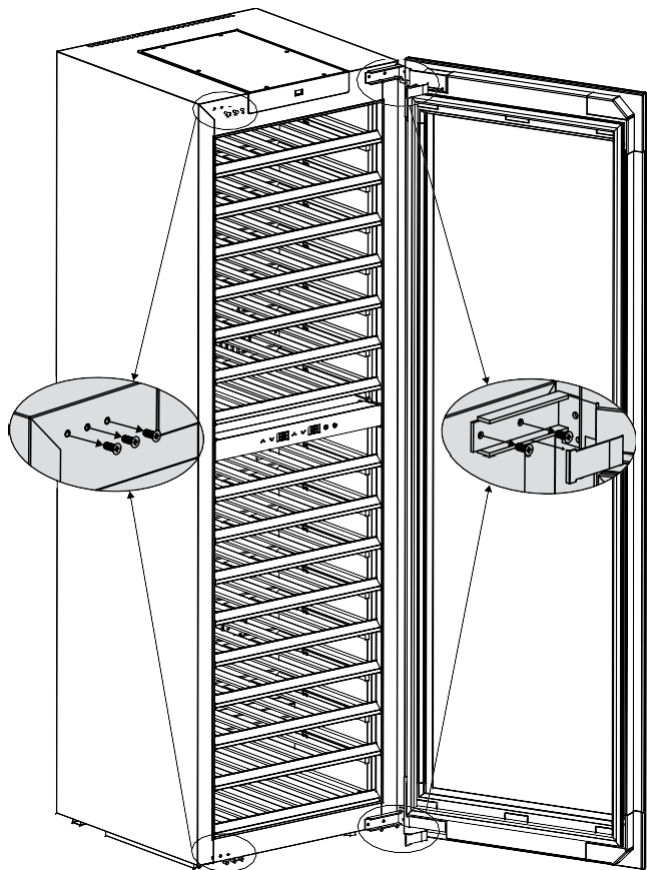

4. Remove the door and rotate it 180°.

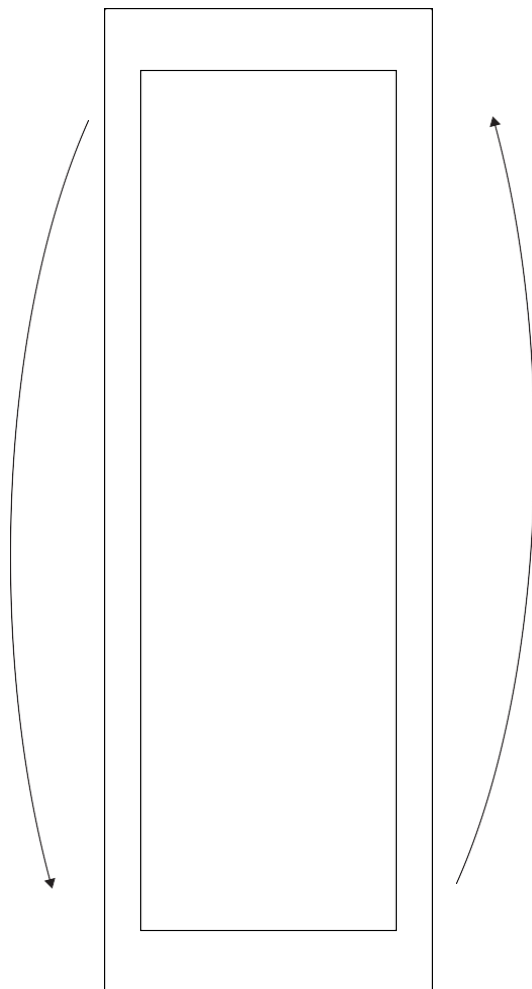

5. Replace the door on the appliance. One person must hold the door while another fits and tightens the screws at the top and bottom of the appliance.

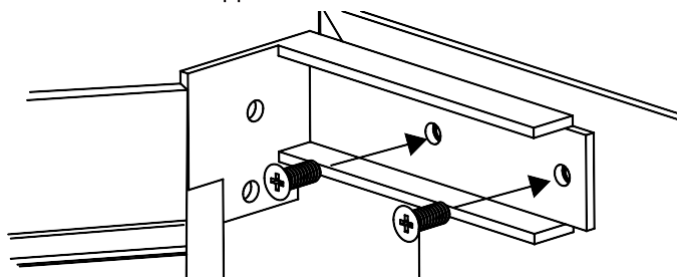

6. Replace the covers. Check that the door is tightly fixed and closes properly.

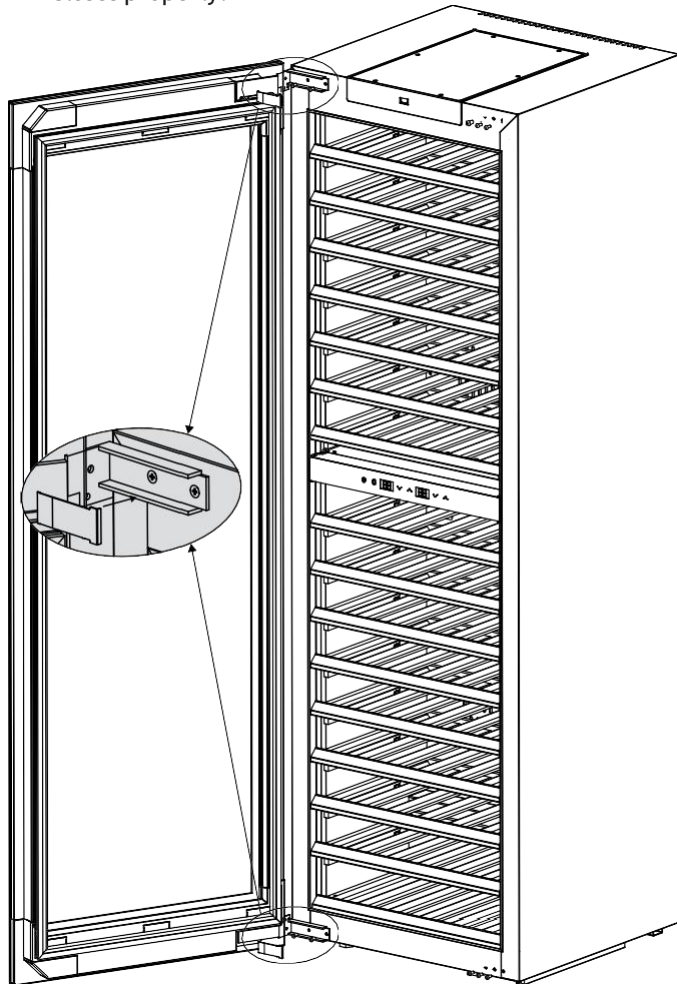

4.6 Installation in a kitchen cabinet

Check the installation dimensions before installation and make sure that you follow the instructions.

⚠ WARNING

Fire hazard due to short circuits!

- ▶ When pushing the appliance into the opening make sure that the power cord is not pinched, caught or damaged.
- ▶ Do not use the appliance if the power cord is defective.
- ▶ The unit is heavy. Fit a supporting plinth foot in the centre of the furniture carcass.

1. Place the power cord near the power socket.
2. Push the appliance into the kitchen cabinet until 2/3 of the appliance is in it.

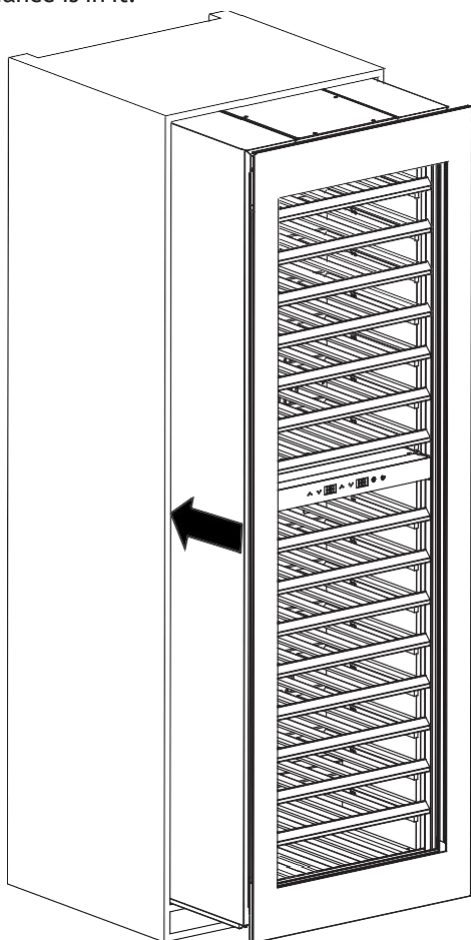

3. Unscrew the adjustable feet until the top of the appliance aligns with the cabinet.

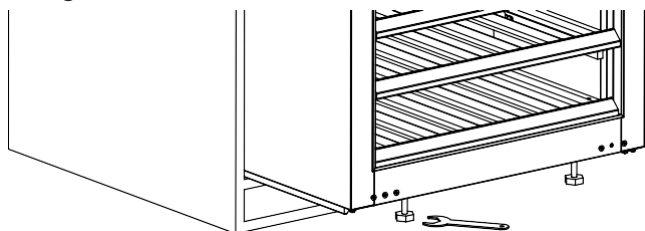

4. Install the hinge cover supplied with the appliance (not essential if space is limited)

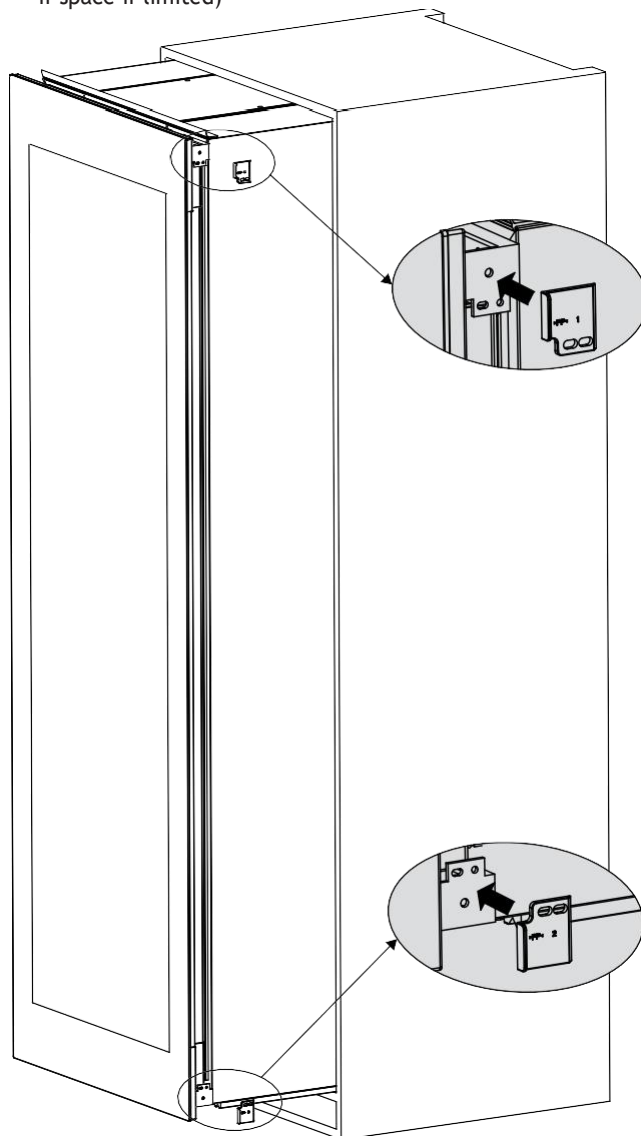

5. Use the supplied suction cup to open the door. To do this, press the suction cup onto the door and turn it until it is firmly attached.

6. Remove the screws on the side which is facing away from the hinges.

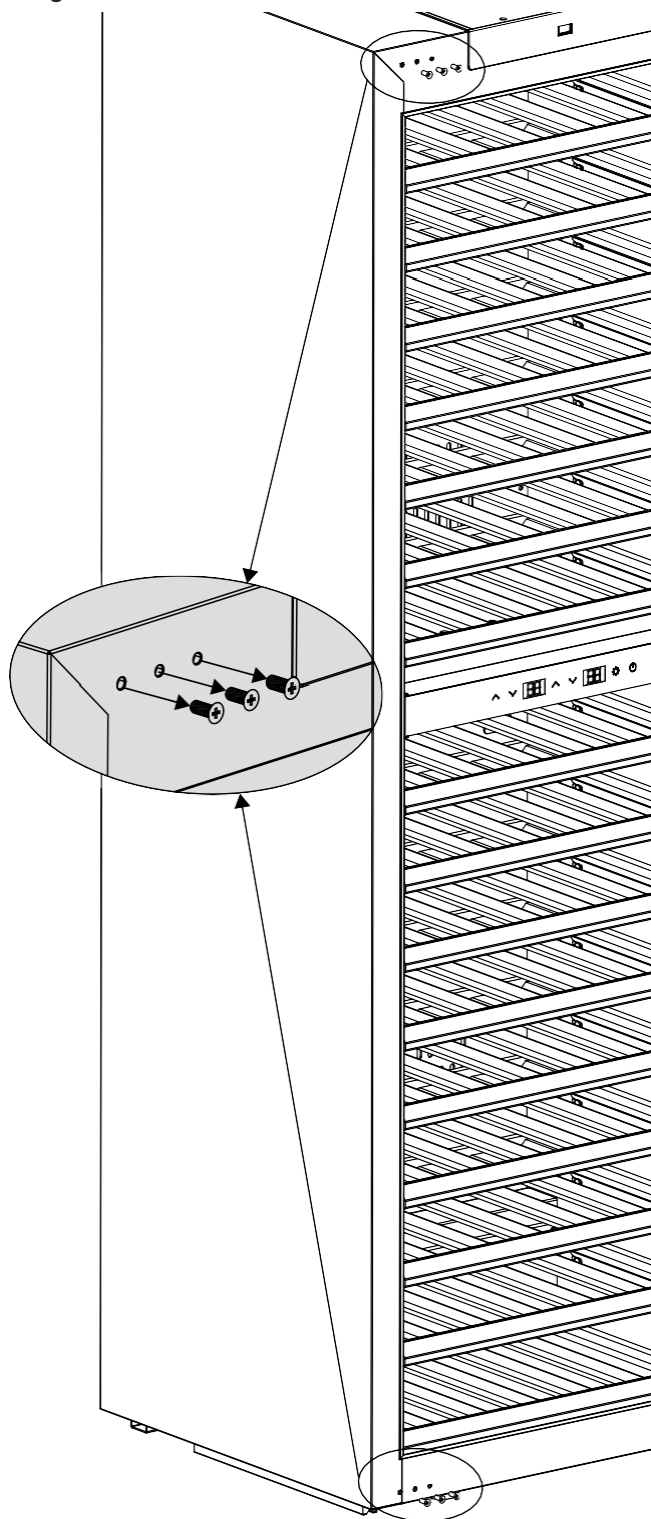

7. Place the spacers on the mounting brackets and screw them together. The position will vary depending on which way the door opens.

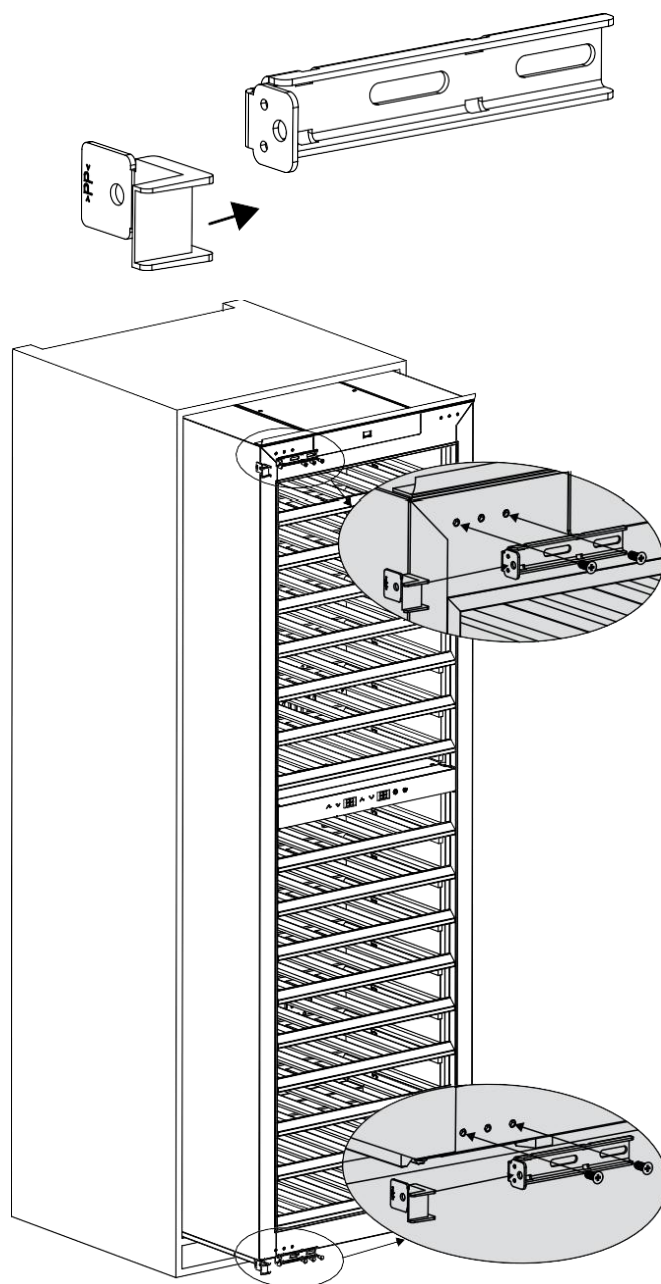

8. Slide the appliance until it is completely in the cabinet. Check all the gaps around the appliance. Use the spacers to position the appliance flush to the front of the cabinet. Loosen the screws (1), slide the spacers towards the side of the cabinet and then continue tightening the screws.

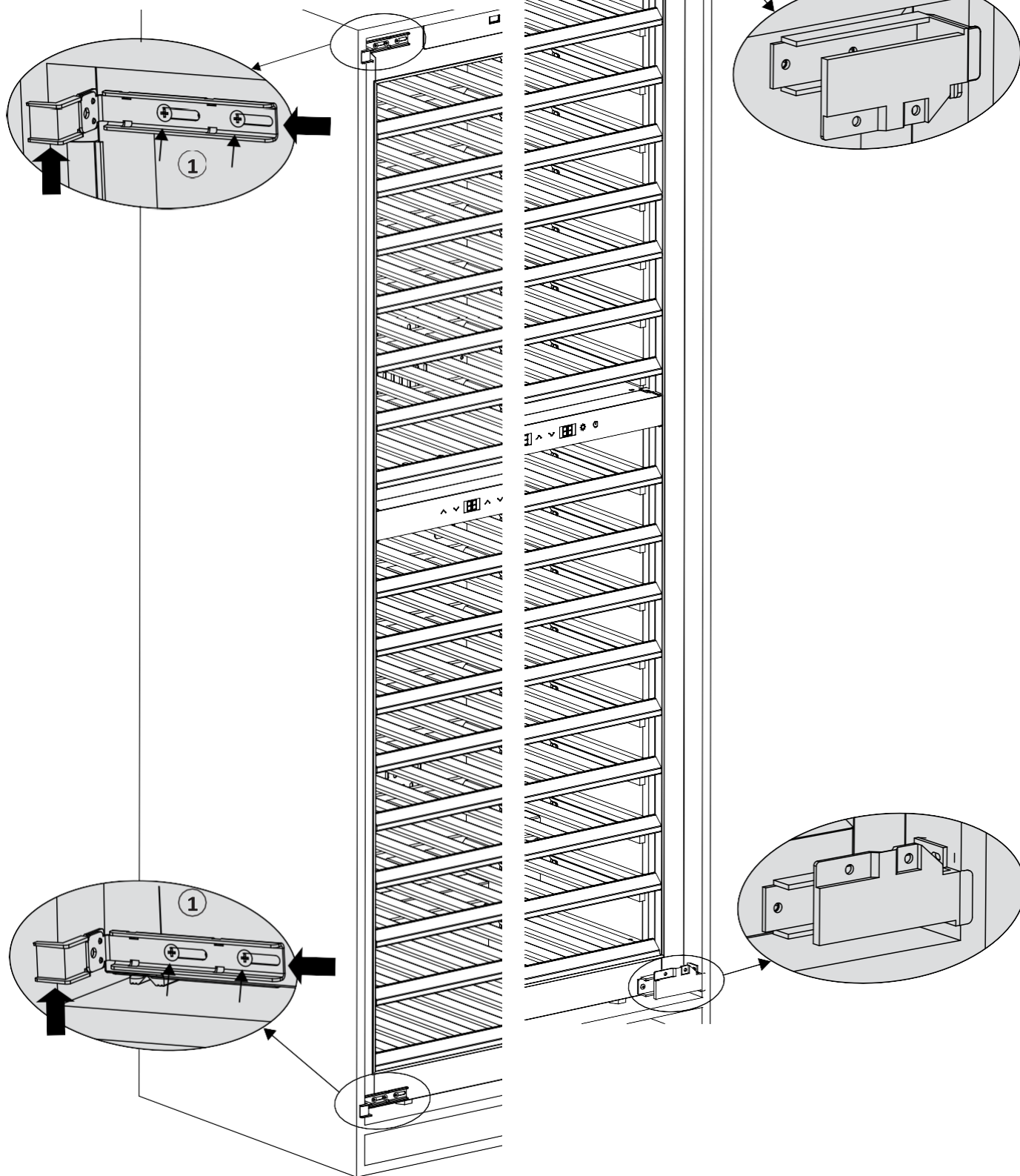

9. Secure the appliance to the kitchen cabinet by pushing the supplied screws through the spacers and the mounting brackets.

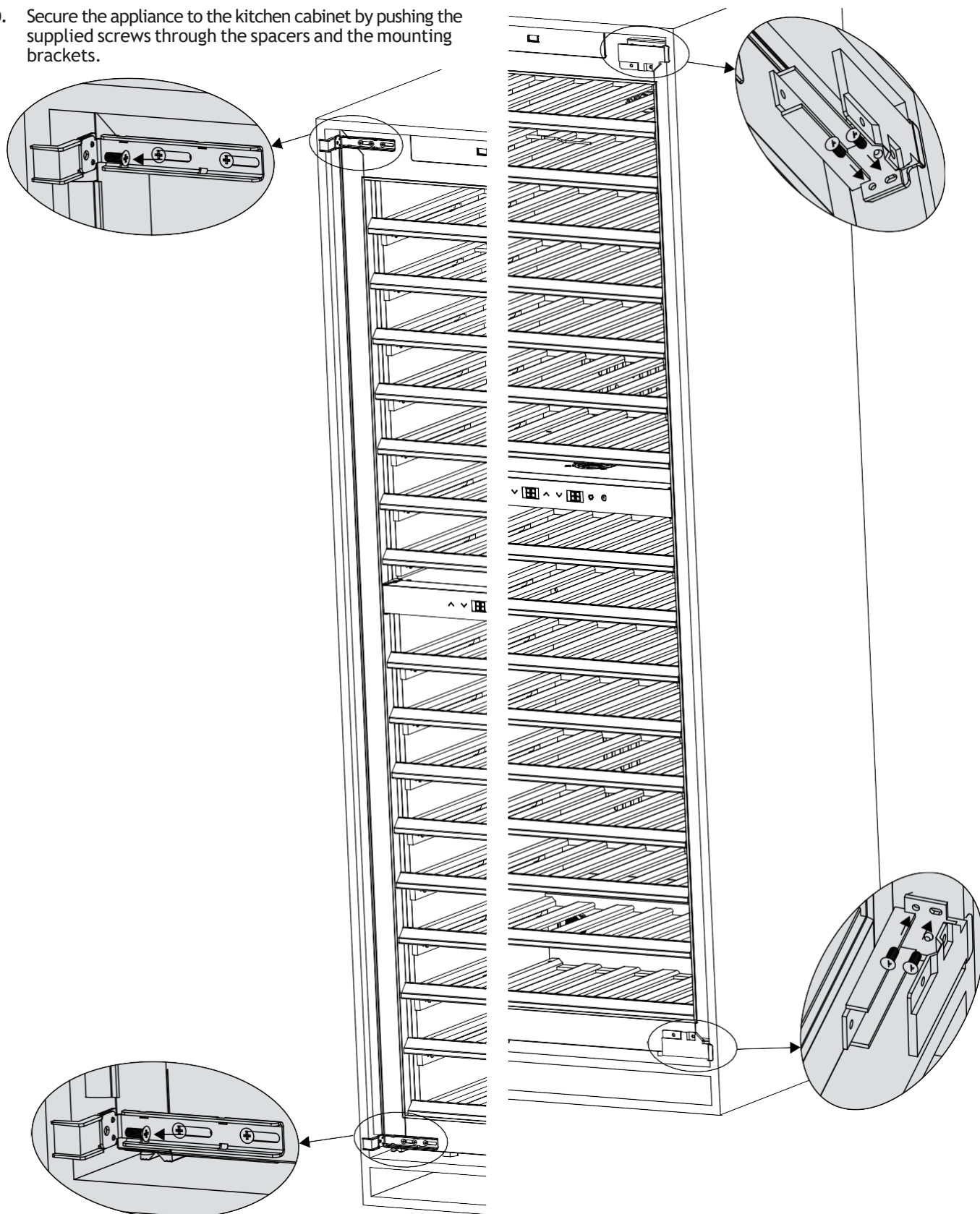

- 10.** Break off the front parts (x) of the spacers. These parts can be thrown away.

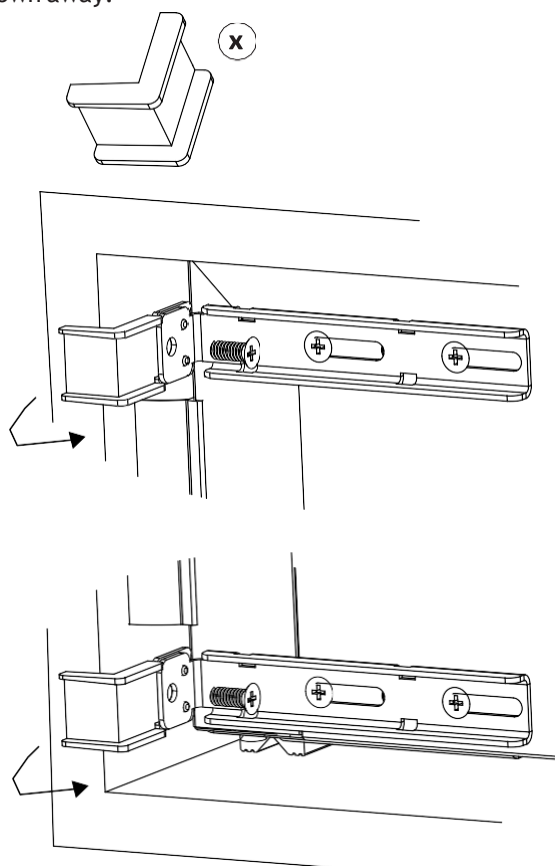

- 11.** Install the supplied covers.

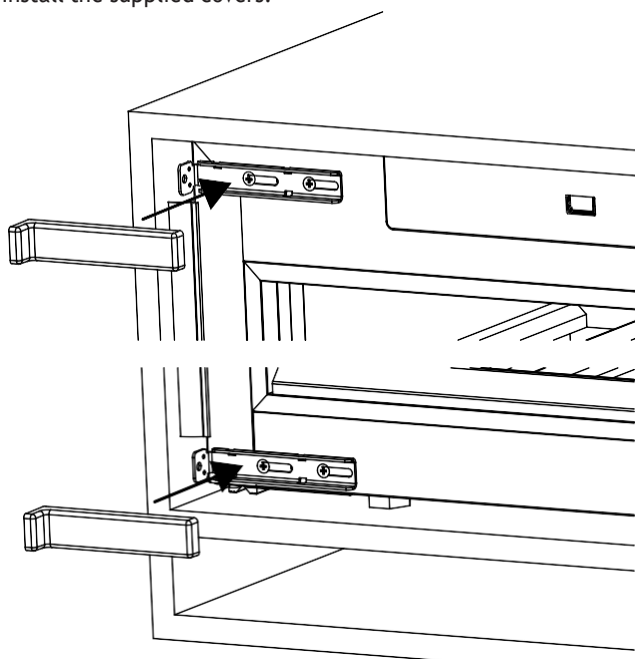

- 12.** Install the supplied cover profiles to cover any gaps, if space is limited then do not use them.

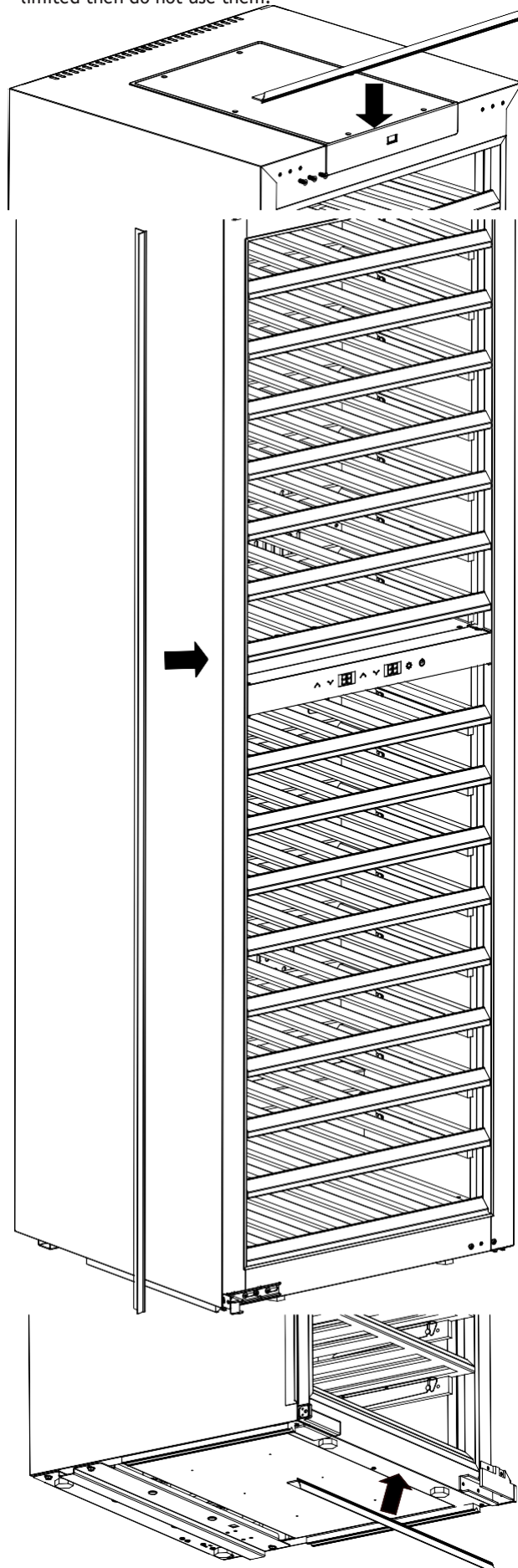

4.7 Aligning the door

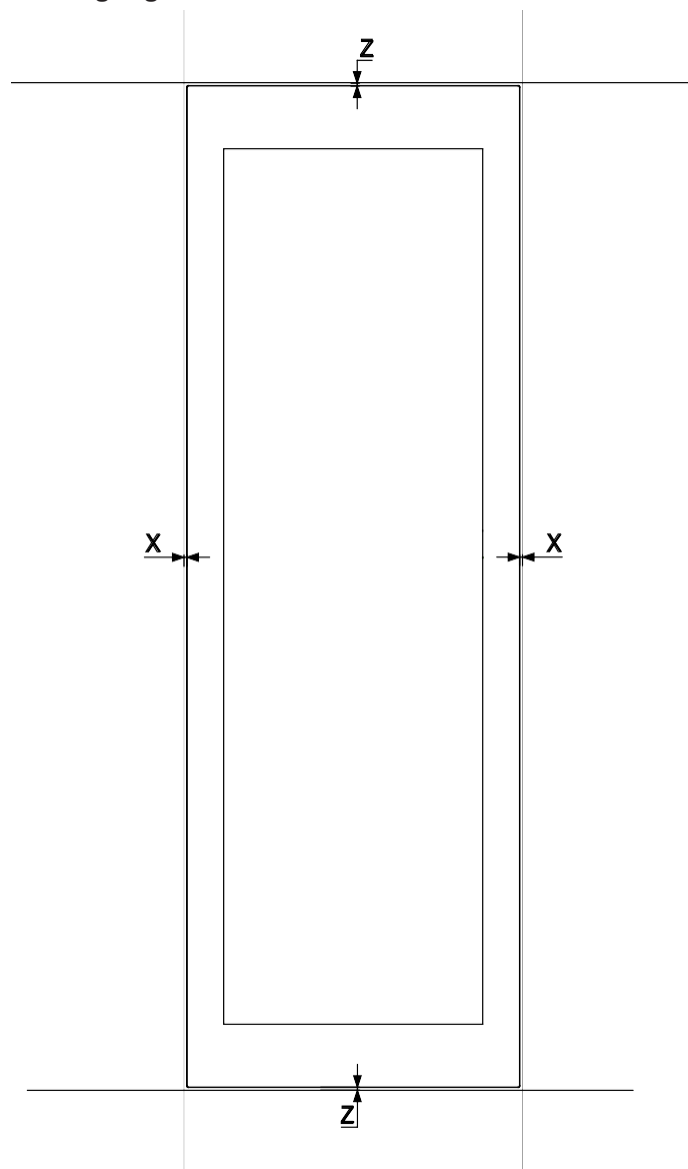

1. To align the door in Direction X, remove the door seal and

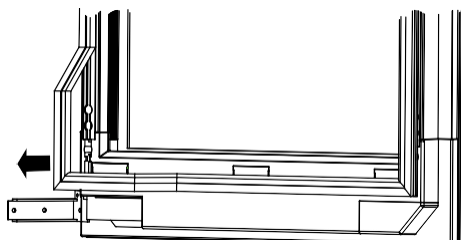
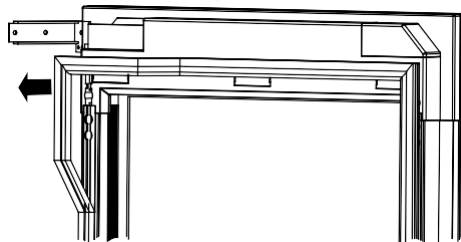

2. the covers.

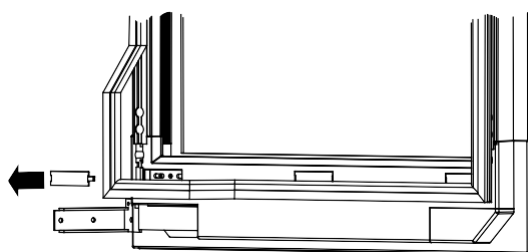
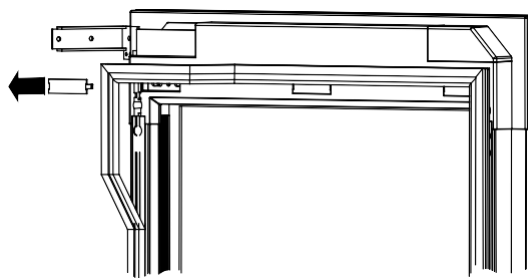

3. Remove the screws in Position 2 and move them to Position 3. Remove the screws in Position 1 and align the door,
4. then tighten the screws in Position 1 and 3.

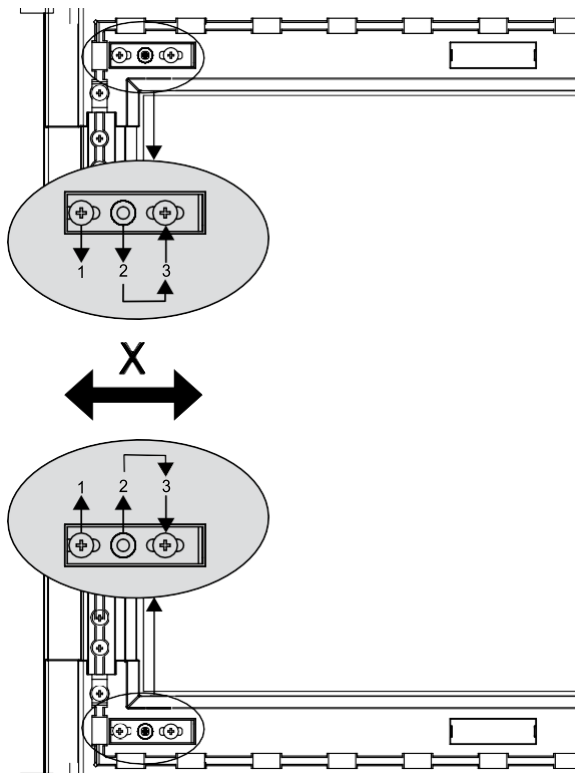

5. Replace the covers and

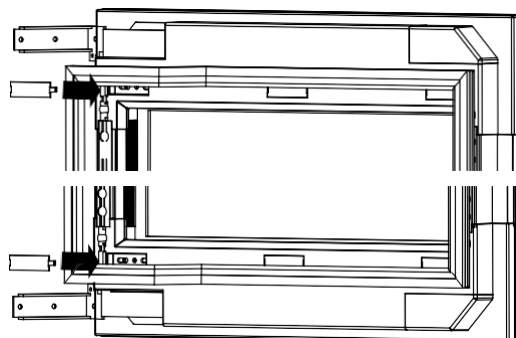

6. the door seal.

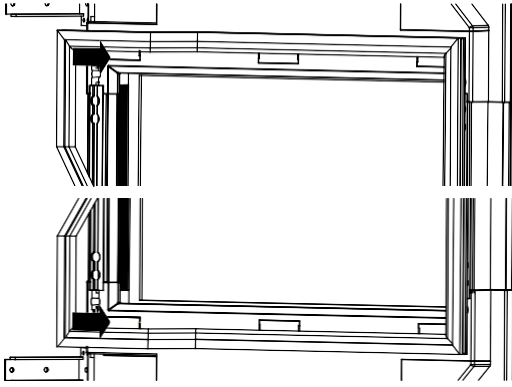

7. To align the door in Direction Z, adjust the height of the feet using the spanner provided.

4.8 How to open the door - handleless/push2open models

- When the appliance has been fully installed and switched on, gently press the door frame to open the door. The sensor will react and the door will open a little. Then pull the door fully open by hand.
- If the appliance is not switched on or the plug is not in the socket, then you will need to use the supplied suction cup to open the door. Place the suction cup in the middle of the door frame and then carefully pull the door open a little. Then pull the door fully open by hand.

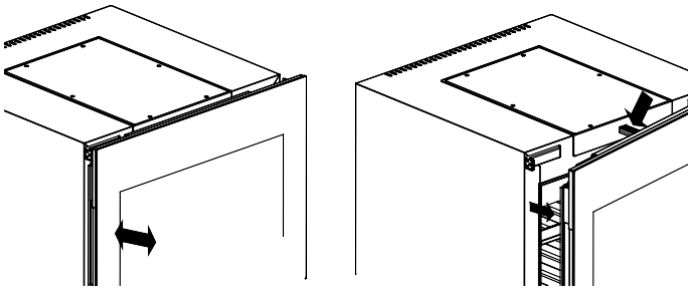

- If your appliance is fitted with a furniture door, the push2open will stick work, although the sensitivity may be reduced due to the weight on the panel.
- If your appliance is fitted with a handle, use the handle to open the door as you would normally.

4.9 Wooden shelves

The upper wooden shelves has ball bearing runners which can be used to pull it out and push it in like a drawer.

4.9.1 How to remove a shelf

1. Pull the shelf as far out of the appliance as it will go and remove the bottles.
2. Lift the shelf up to detach it from the runners.
3. Remove the shelf from the appliance.

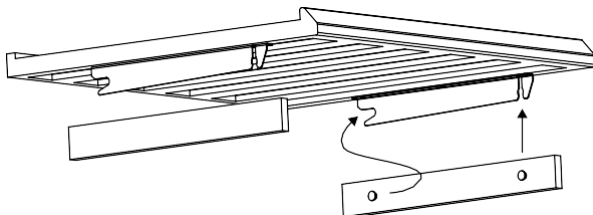

How to insert a shelf

1. Pull the runners out as far as they will go.
2. Place the back of the shelf on the runners behind the pins.
3. Push the shelf into the appliance and press down at the front until it clicks into the front pins.
4. Push the shelf back into the appliance as far as it will go.

PLEASE NOTE

- ▶ Make sure that the shelves are firmly engaged in place before storing any bottles.
- ▶ Spread your bottles out as evenly as possible over the shelves.
- ▶ Do not store bottles in the appliance unless they are on a shelf, otherwise they may fall out when the appliance door is opened. This may cause injury or material damage.
- ▶ To ensure that the door shuts correctly, make sure that shelves are pushed into the appliance as far as they will go.

4.9.2 Wood storage shelf with presentation rack

You can mount a display rack on the wooden storage shelves to display 4 bottles in your appliance (see „Bottle storage“). To do this, the wooden storage shelf above must be removed.

1. Remove the bottles.
2. Remove the desired wooden shelf and the one above it.
3. There are pre-drilled holes on the top of the base.
4. Insert the stainless steel fixtures into the holes.
5. Place the assembled shelf in the appliance.

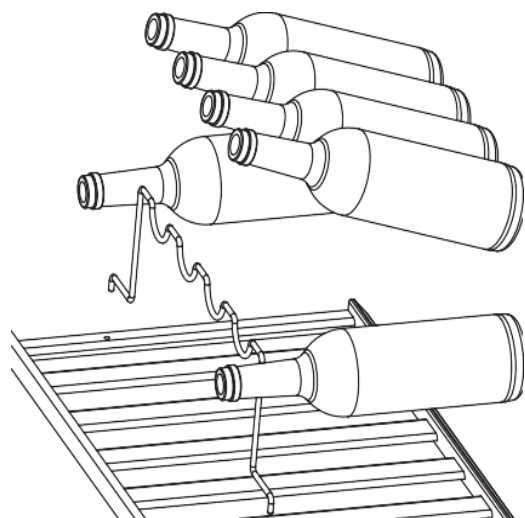
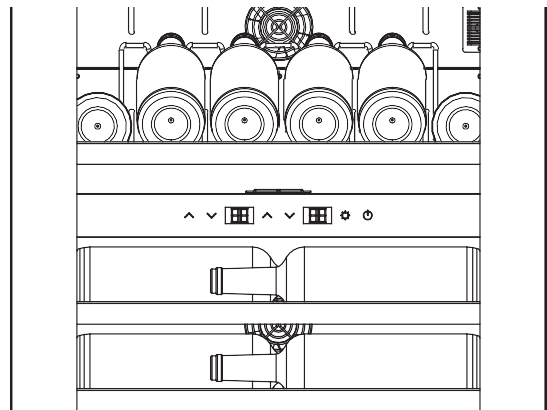

4.10 How to change the activated carbon filter

Replace the activated carbon filter once a year.

1. To do this, remove the bottles which are in front of the filter.
2. To replace the existing filter, pull it out and insert a new one.

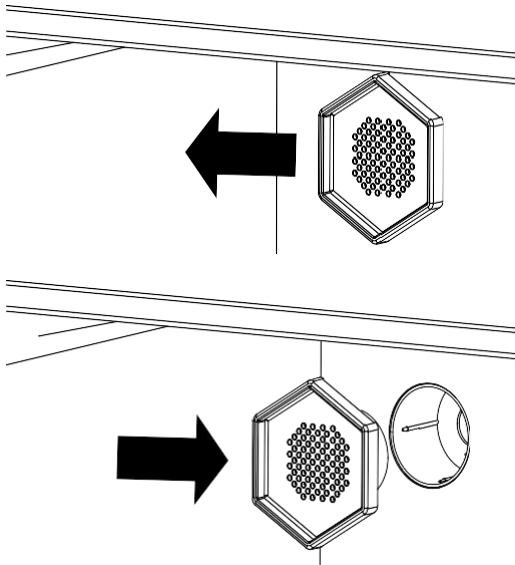

4.11 Rating plate

The rating plate with the connection and performance data can be founded on the back of the device or some models will be inside the fridge at the bottom left.

5 Operation and Handling

This chapter provides you with important notices with regard to operating the appliance.

5.1 Operating elements

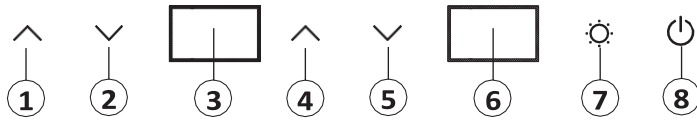

- | | |
|-------------------------------------|-------------------------------------|
| ① Increase temperature (upper Zone) | ⑤ Decrease temperature (lower Zone) |
| ② Decrease temperature (upper Zone) | ⑥ Display (lower Zone) |
| ③ Display (upper Zone) | ⑦ Light control |
| ④ Increase temperature (lower Zone) | ⑧ On / Off |

5.1.1 Symbols shown on the control panel

ECO ECO mode is active

Unit reduces the temperature: The symbol goes out as soon as the unit has reached the set temperature.

Unit increases the temperature: The symbol goes out as soon as the unit has reached the set temperature.

Door is closed

°C Temperature display in °C

°F Temperature display in °F

5.2 Operation of the appliance

PLEASE NOTE

- ▶ Due to the appliance's 2-zone cooling and ventilation system, temperature settings for each zone are independent of the other zone.
- ▶ This means that the temperature of the lower zone cannot be set below that of the upper zone.
- ▶ When using both zones with different storage temperatures the temperature in the upper zone can thus only be lower or the same as the temperature in the lower zone.
- ▶ A large difference in the temperature settings for each zone can result in higher energy consumption.

5.2.1 Switching on and off

1. Plug the power socket into mains power.
2. The On / Off button flashes.
3. Press the On / Off button.
4. The last selected temperature will be shown on the control panel.
5. To switch the appliance off, press the On / Off button until the symbols on the control panel disappear.

5.2.2 Setting the temperature

1. Turn the appliance on.
2. The last selected temperature will be shown on the control panel.
3. By pressing the two left arrow keys simultaneously, you can switch between the temperature display in °C and °F.
4. The selected temperature unit is saved when the corresponding symbol on the control panel stops flashing and is permanently on.
5. Use the arrow buttons to set the temperature in 1° increments from 5 °C to 20 °C (41 °F to 68 °F).

6. The desired temperature will be stored approx. 5 seconds after the last time you press a button and the symbol on the control panel stops flashing and is permanently on.
7. The appliance's current temperature is shown.

PLEASE NOTE

- ▶ Temperature recommendations: Red wine: 12 °C - 18 °C and white wine: 6 °C - 10 °C.
- ▶ The appliance can achieve the best cooling and consumption results at a recommended ambient temperature of 16 - 20 °C.
- ▶ The temperature in the appliance depends on the ambient temperature, the quantity of bottles and the chosen temperature.
- ▶ Please note that your appliance is intended to cool wine. The maximum temperature which can be achieved inside the cooler should NOT significantly exceed the ambient temperature in the room.

5.3 Illumination

5.3.1 Setting the "ECO" mode

If you select the "ECO" mode, then the appliance's interior light will turn off when the door is shut.

1. Press the "Light" button.
2. The "ECO" symbol will appear on the control panel display.
3. Shut the door.
4. The LED light will turn off. Next time you open the door, the light will turn on again.
5. To deactivate the "ECO" mode, press the "Light" button again. The LED strips will be permanently on, also when the door is closed.

PLEASE NOTE

- ▶ The illumination will switch off after 4 hours to save energy.

5.3.2 Setting light intensity

The light intensity can be set at 4 levels. They are 25 %, 50 %, 75 % and 100 %.

1. Turn the appliance on.
2. The LED strips will light up.
3. Press the "Light" button for a few seconds.
4. The appliance will briefly beep once.
5. Briefly press the "Light" button again to select the desired lighting level (L1 - L4).

5.4 How to turn off the sound

To switch off the sound of the appliance, press the right down arrow and the light key at the same time. You can also use this button combination to turn the sound back on.

6 Cleaning and Maintenance

This chapter provides you with important notices with regard to cleaning and maintaining the device. Please observe the notices to prevent damages due to cleaning the device incorrectly and to ensure trouble-free operation.

6.1 Safety information

⚠ ATTENTION

Please observe the following safety notices, before you commence with cleaning the device:

- ▶ Prior to commissioning, clean the appliance thoroughly.
- ▶ Turn the appliance off prior to cleaning, remove the plug from the wall socket and remove all the bottles.
- ▶ Do not clean the appliance with hard, scratchy or abrasive cleaning agents such as steel wool or the like.

6.2 Cleaning

◆ Interior

Clean the interior surfaces with lukewarm water, a soft cloth and mild detergent. Use a soft cloth to dry the appliance thoroughly.

◆ Door seal

To keep the appliance running efficiently, make sure that the door seal is kept clean. The door seal can be removed for cleaning with a damp cloth.

◆ Cabinet

The cabinet should be cleaned with a mild detergent and warm water. Use a soft, damp cloth for drying.

◆ Exhaust vent/Ventilator

The exhaust vent may become blocked - e.g. by dust - thus impairing the appliance's cooling efficiency. If necessary, use a vacuum cleaner to remove any blockage to the exhaust vent.

7 Troubleshooting

This chapter provides you with important notices with regard to operating the device. Observe the following notices to avoid dangers and damages.

7.1 Safety notices



⚠ ATTENTION

- ▶ Only qualified electricians, who have been trained by the manufacturer may carry out any repairs on electrical equipment.
- ▶ Improperly performed repairs may result in personal injury or damage to the device.

7.2 Troubleshooting table

The following table assists in localizing and rectifying minor faults.

Fault	Possible cause
Cooling performance is unsatisfactory.	<ul style="list-style-type: none">• Check the temperature control setting.• External environment may require another setting.• The door is open too often.• The door is not fully closed.• The door seal does not seal properly.• The wine cooler does not have sufficient clearance.• External environment may require another setting.
The light does not work.	Contact our Customer Service.
Vibrations and/or the appliance is too loud. The door does not close correctly.	<ul style="list-style-type: none">• Check that the appliance is standing level.• The door does not close correctly.• The door was installed the wrong way round or incorrectly.• The seal is worn out. The shelves are out of position.

No running noises can be heard (compressor).	The compressor does not start when the ambient temperature is lower than the desired temperature.
Gurgling sound of liquid.	The sound of the compressor when it starts or stops. The sound of refrigerant flowing through the refrigeration system.
Automatic door opener does not work.	Remove the seal and knead it. Replace the seal.
Error code H1 and  appears in the display	The door has been open for more than 1 minute. Temperature loss in the interior.
Error code H2 and  appears in the display	Temperature sensor error - Contact our Customer Service.
Error code H3	Refrigerant leak - Contact our Customer Service.
Error code „-“	Faulty compressor performance - Contact our Customer Service.

PLEASE NOTE

- ▶ If you cannot solve the problem by carrying out the steps described above, our Customer Service will help you free of charge.

8 Disposal of the Old Device

Old electric and electronic devices frequently still contain valuable materials. However, they also contain damaging substances, which were necessary for their functionality and safety. If these were put in the non-recyclable waste or were handled incorrectly, they could be detrimental to human health and the environment. Therefore, do not put your old device into the non-recyclable waste under any circumstances.



PLEASE NOTE

- ▶ Utilise the collection point, established in your town, to return and recycle old electric and electronic devices. If necessary, contact your town hall, local refuse collection service or your dealer for information.
- ▶ Blowing gas inside the unit is flammable. The disposal of this flammable material should be in accordance with national regulations.
- ▶ Ensure that your old device is stored safely away from children until it is taken away: Remove the drawer doors, the partitions and the movable inserts in the inner space, so that children cannot be accidentally injured.

8.1 Disposal of the packaging

The packaging protects the device against damages during transit. The packaging materials are selected in accordance with environmentally compatible and recycling-related points of view and can therefore be recycled.



9.0 Warranty and aftersales

If you are still experiencing issues with your wine fridge, please email us with the below information:

SERIAL NUMBER AND MODEL NUMBER
DATE OF PURCHASE AND PROOF OF PURCHASE
INSTALLATION PHOTOS
DESCRIPTION OF FAULT
SERVICE ADDRESS & CONTACT NUMBER

As we continuously looking to improve our products for the benefit of our customers. We reserve the right to modify technical and aesthetic characteristics without notice, which means our products may change from batch to batch. the company is not liable for any costs involved if replacement products are not identical.

Warranties for the products are offered by the company and exclusive distributors. No part of these instructions may be considered as a supplementary guarantee. We cannot be held liable for errors or technical or editorial omissions in this document.

Your wine or beverage cooler will come with a 3-year parts and labour warranty. It is extremely important you follow the installation and operation instructions to avoid voiding the warranty. Should any of the instructions not be followed correctly, we reserve the right to cancel the warranty, both parts and labour applicable.

Warranty terms and conditions

- I. Damage in transit or when moving the appliance after delivery are not covered under the warranty obligations.
- II. Damage caused by accident, negligence or improper use will invalidate the warranty. This also follows for improper installation/service, other than those described in the user manual.
- III. Damage caused by connecting your product to an incorrect power supply are not covered under the warranty terms
- IV. Damage from any power failure on the property
- V. Incorrect or faulty installation will void the warranty of the product. This also includes any modifications made during the installation process
- VI. Damage caused by unauthorized repair will invalidate the warranty

- VII. Any damage resulting from force majeure. This includes fire or any natural disaster will not be covered under the warranty obligation.
- VIII. Any alterations to the product, without obtaining permission from the manufacturer will invalidate the warranty
- IX. Any aesthetic parts such as door or door seals, handles, hinges, lights, shelves or plastic are not covered under the warranty terms
- X. Any spoilage or damage to the wines is not covered under the warranty obligations (or any other contents incidental or consequential to possible defects of the unit).
- XI. Parts will be replaced with the same or equivalent parts should the product have been updated, if the product has been discontinued, we reserve the right to replace with the closest equivalent product available from the range at that time.
- XII. The warranty applies to only the original purchaser, it can not be transferred after initial ownership
- XIII. We do not cover the warranty obligations for goods sold through resale sites such as Ebay, Gumtree - these are not authorized dealers.
- XIV. We cannot be held responsible for loss of income or any costs incurred during down time of the appliance.

Please note - warranty clauses and specifications are subject to change without notice. This is a non-binding document.

